

# Prefabricated Data Center

## FusionModule1000A Prefabricated All-in-One Data Center

### Introduction

Huawei FusionModule1000A is an advanced outdoor and prefabricated all-in-one data center facility solution. The solution provides reliable, stable and green environment for IT equipment. The solution can be applied to multiple industries and scenarios and meet data center's requirements on energy saving and fast deployment.

### Applicable Industry and Scenario

**Enterprise:** small data center

**Government:** data center of smart city and safe city

**Education:** data center of university and science institute

**Energy:** on-site data center of mining and exploration

**Finance:** backup data center

**Transportation:** power supply for non-IT room of airport/railway station/port

**Telecom carrier:** small IT room, small IDC, DR equipment room



FusionModule1000A 40ft

### Features & Value

#### Simple

- Enclosure, power, cooling, firefighting and DCIM system are prefabricated. All facilities are pre-installed and pre-tested before delivery. It minimizes the engineering work and the on-site installation only takes one day.
- Moveable design make relocation easy and deployment flexibly.

#### Efficient

- High-efficiency modular UPS, in-row inverter A/C, aisle containment, enclosure of low heat transfer coefficient, industry-leading PUE
- Huawei NetEco system (optional) centralize the management of multiple sites.
- O&M anytime and anywhere with mobile APP

#### Reliable

- 2N scenario meets Uptime Tier III requirement
- IP55 protection (IP65 optional) and GR-63-CORE Zone3 anti-seismic
- Durable enclosure, 120min fire-resistance when painted with customized coating, EN 1627~EN 1630 Class 3 anti-theft, multiple access control and video surveillance protect the asset

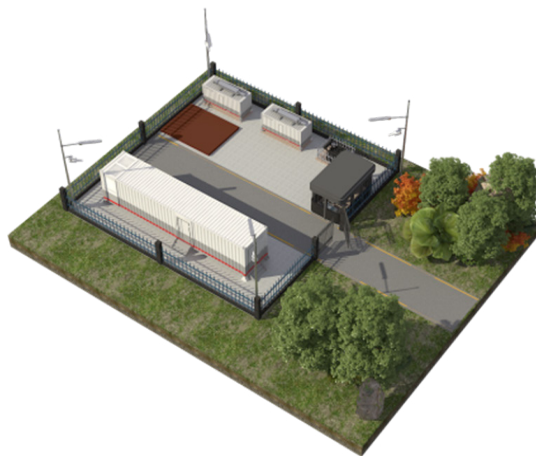

FusionModule1000A Site Scenery

System	Sub-item	FusionModule1000A 40ft-IT-N+X-380V <sup>⑦</sup>	FusionModule1000A 40ft-IT-2N-380V <sup>⑦</sup>
Power	Total IT load	≤ 54kW	
	Power density per rack	≤ 9kW	
	Input mode	2x320A input, 3Ph+N+PE, 380V /400V/415V AC,50Hz/60Hz	
	UPS model	Integrated modular UPS (with integrated ATS and 25kVA module)	Integrated modular UPS (with integrated MCCB and 25kVA module)
	UPS capacity	75kVA	
	Number of UPS power module	3+1 redundancy	3
	BAT backup time <sup>①</sup>	7.5min	10min
	rPDU	1) Power density of 6kW/rack: basic type, full-height rPDU A route:IEC320 20 × C13+2 × C19 B route:IEC320 20 × C13+2 × C19 2) Power density of 9kW/rack: basic type, half-height rPDU A route: ( IEC320 9 × C13+3 × C19 ) x2 B route: ( IEC320 9 × C13+3 × C19 ) x2	
	Surge protection <sup>②</sup>	Level-3, maximum 40kA 8/20us Level-2, maximum 60kA 8/20us	
Rack	Rack capacity <sup>③</sup>	8 × 42U IT rack	7 × 42U IT rack
	Rack Distribution	2 × 9kW/ Rack+6 × 6kW/ Rack	4 × 9kW/ rack+3 × 6kW/ rack
	Size (H × W × D)	600*1100*2000 mm 600*1200*2000mm	
Cooling	A/C type	Air-cooled in-row PAC	
	Sensible cooling capacity	25kW/unit (3+1 redundancy)	
	Coolant	R410A	
	Fan type	EC fan	
	Compressor	DC variable-frequency	
	A/C group control	Support	
	Temp. range	18~27°C	
	Humidity range	20%~80%	
	Hot/cold aisle	Hot aisle containment	
	Humidification	Electrode humidifier	

System	Sub-item	FusionModule1000A 40ft-IT-N+X-380V <sup>⑦</sup>	FusionModule1000A 40ft-IT-2N-380V <sup>⑦</sup>
Fire protection	Auto fire protection system	Automatic fire detection & suppression system c/w emergency release function	
	Alarm	Automatic monitoring and detection, support sound and light alarm	
	Gas	Standard HFC-227ea optional NOVEC1230	
Monitoring	Module access	IC card reader as default optional three-in-one access control	
	Rack access	Customization <sup>⑥</sup>	
	Monitoring management	Real-time monitoring of temperature and humidity control, fire control, access control and cooling system	
	In-module display	PAD	
	Remote O&M	App	
	E-mail	Customization	
	SNMP short message	Customization	
Enclosure	External size (H × W × D)mm	2896 × 2438 × 12192	
	Aisle width	Long aisle of 650-750mm; cold aisle of 1150mm; hot aisle can be extended to 610mm;	
Protection	Dustproof and waterproof	IP55 (optional IP65)	
	Anti-seismic	GR-63-CORE Zone3	
	Anti-theft	Meet requirements of EN 1627~EN 1630 Class 3	
Operating Environment	Operating humidity (RH)	5% ~ 95%	
	Operating temp. <sup>④</sup>	-20°C~+55°C	-40°C~+55°C
	Altitude <sup>⑤</sup>	≤ 4000m	

① ③: The BAT backup time and rack capacity vary in configuration. Details refer to the Product Overview.

②: Surge protection level vary in configuration. Details refer to the Product Overview

④: Low-temperature air-conditioner is required for -40°C to -20°C.

⑤: Output power derating is required when the altitude is over 1000m.

⑥: Customerized access control will cause changes to U space and monitoring solution.

⑦ N+X and 2N refers to redundancy level of power system. N+X refers to UPS module redundancy. 2N refers to UPS unit redundancy.

No part of this document may be reproduced or transmitted in any form or by any means without prior written consent of Huawei Technologies Co., Ltd.

## General Disclaimer

The information in this document may contain predictive statements including, without limitation, statements regarding the future financial and operating results, future product portfolio, new technology, etc. There are a number of factors that could cause actual results and developments to differ materially from those expressed or implied in the predictive statements. Therefore, such information is provided for reference purpose only and constitutes neither an offer nor an acceptance. Huawei may change the information at any time without notice.

## HUAWEI TECHNOLOGIES CO., LTD.

Huawei Industrial Base  
Bantian Longgang  
Shenzhen 518129, P.R. China  
Tel: +86-755-28780808

[www.huawei.com](http://www.huawei.com)